

features

- True Multiplex 6 Channel Distributed Audio
- Integrated Fire Phone, Area of Rescue and Fan & Damper Control capability
- Modular System - components added as needed
- Integrated 2 Channel Digital Message Repeater
- Live Microphone Page to any zone
- Fast RS-485 Communication Protocol
- Fully Supervised
- Easy Installation and Operation
- Natural Sound Voice Recordings
- Built in Alarm and Alert Signals
- Up to 4 Minute Message Capacity
- Works with 12VDC or 24VDC Fire Alarm Panel
- Works with Analog/Addressable and Microprocessor based Fire Alarm Panels.
- 3 Minute Message Restart on Microphone Key

The Morley ZVX High Rise Evacuation System operates in conjunction with the Fire Alarm Control Panel (FACP) in a building to provide automatic response to life safety emergencies.

The Morley ZVX includes all necessary features to provide an effective voice evacuation system. The Morley ZVX can be custom configured to satisfy the needs of any high rise application.

Fire department authorities can easily take command of evacuation or relocation procedures and emergencies. Building management and fire brigades can monitor and control emergency response even before the professionals arrive

The ZVX system includes capacity for 6 channels of simultaneous audio. This provides for evacuation, stay-in-place, or other public address announcements and automatic messages.

Fire Fighter Phones or Warden Stations may be included as required. Area-of-Rescue stations can reassure handicapped occupants that help is on the way.



Charles Avenue, Burgess Hill
West Sussex, RH15 9UF
United Kingdom

Tel: +44 (0) 1444 23 55 56
Fax: +44 (0) 1444 25 44 10
Email: sales@morleyias.co.uk
www.morley-ias.co.uk

A Honeywell Company

Morley ZVX-MP High Rise Voice Evacuation System Master Panel Data Sheet

We reserve the right to amend any design or specification in line with our policy of continuing development and improvement. © Morley-IAS Fire Systems 2004.

ZVX-MP64/P Master Panel Ribbon Cable Connection Detail

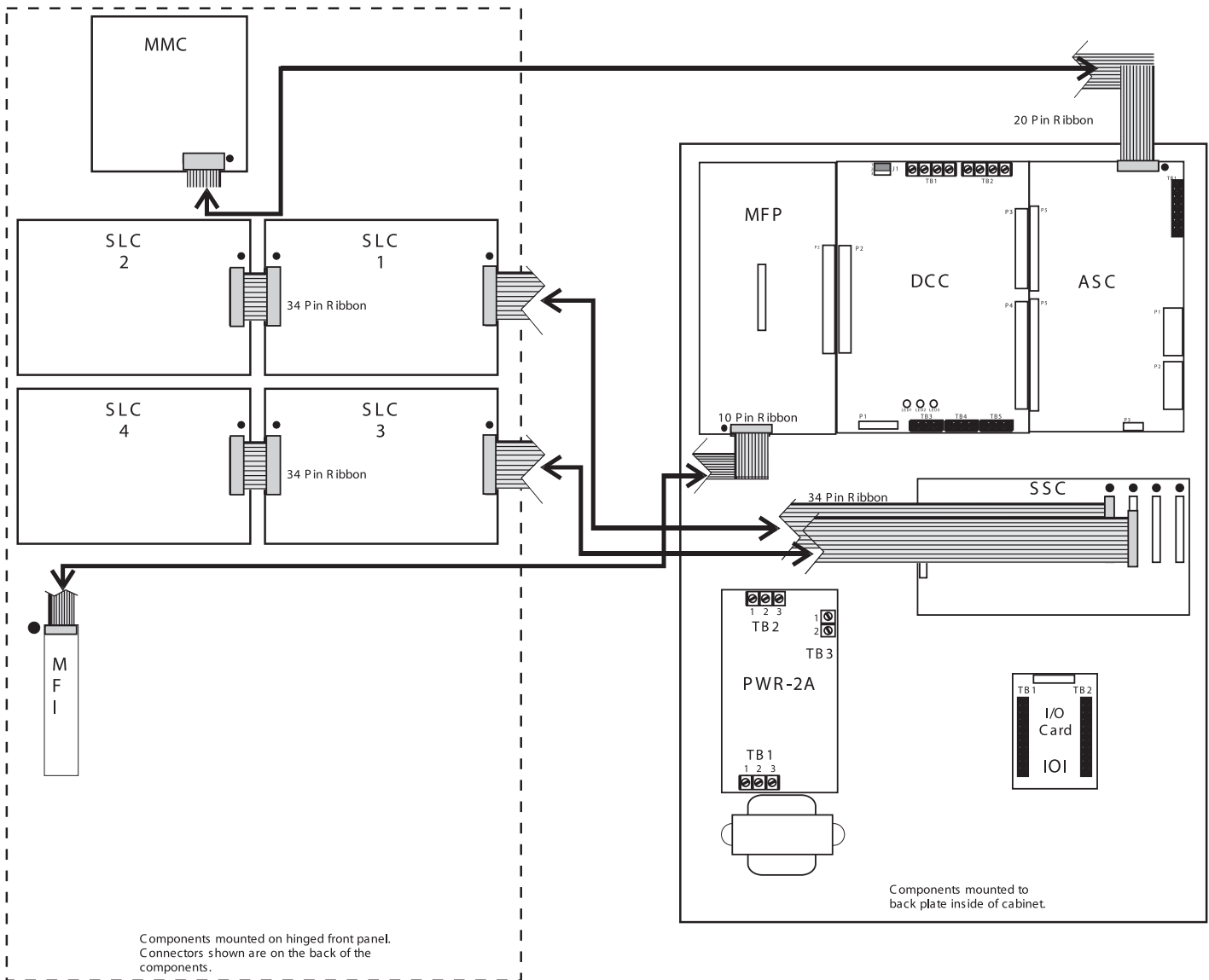

In the Master Panel system components are mounted to a removable back plate. The door and front panel are removable. This enables field wiring to be installed cleanly.

Connections to the User Interface components (Switch/LED banks, Mic/System control and Master Fire Phone) is accomplished with ribbon cables. The front panel mounts separately on a continuous hinge so once installed the access for system programming is easily accommodated.

NetComm Loop Wiring (Style 4)

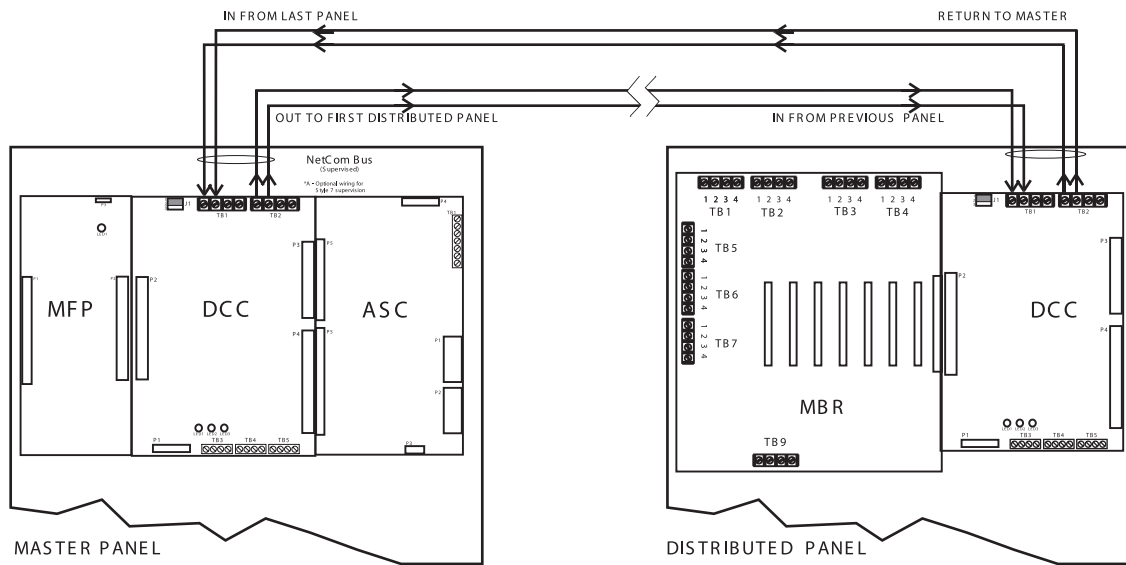

NetComm Loop Wiring (Style 7)

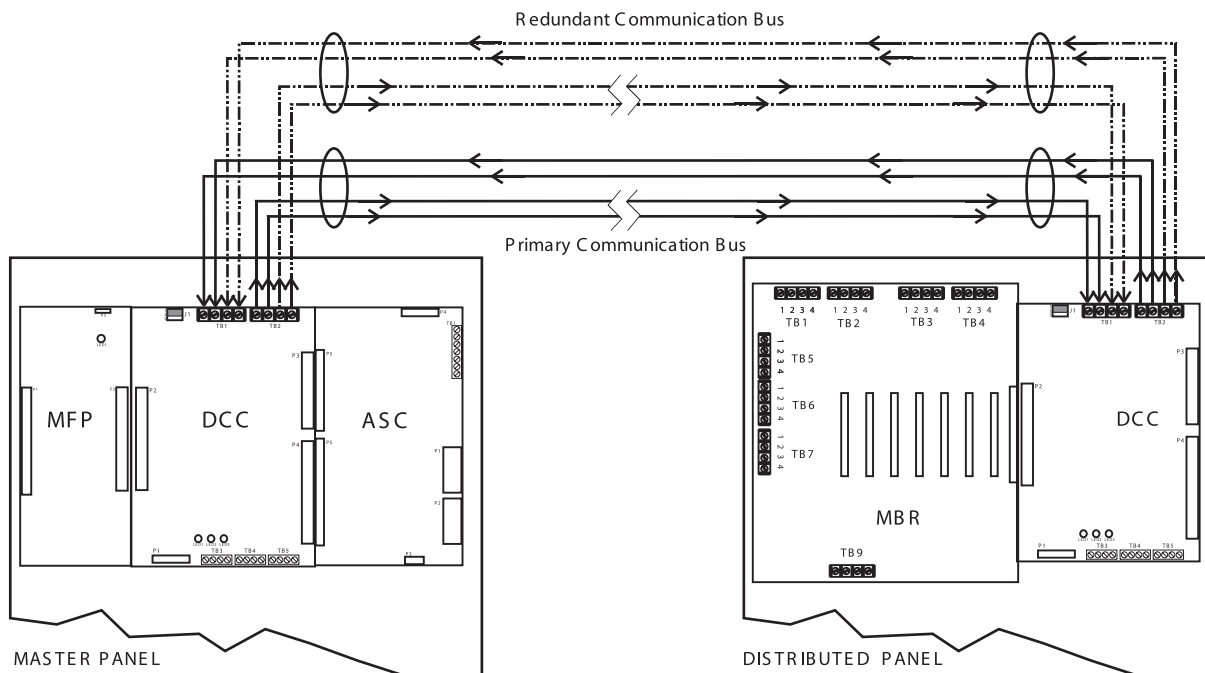

The redundant loop must be run in separate conduit with minimum spacing from the primary. Check local code requirements.

distributed panel configurations

ZVX-MP16	Master Panel, 16 Switch Control
ZVX-MP32	Master Panel, 32 Switch Control
ZVX-MP48	Master Panel, 48 Switch Control
ZVX-MP64	Master Panel, 64 Switch Control
ZVX-MP80	Master Panel, 80 Switch Control
ZVX-MP96	Master Panel, 96 Switch Control
ZVX-MP16/P	Master Panel, 16 Switch Control, Master Fire Phone
ZVX-MP32/P	Master Panel, 32 Switch Control, Master Fire Phone
ZVX-MP64/P	Master Panel, 64 Switch Control, Master Fire Phone
ZVX-MP80/P	Master Panel, 80 Switch Control, Master Fire Phone
ZVX-MP96/P	Master Panel, 96 Switch Control, Master Fire Phone

panel options

Cards may be added as job requirements demand

VX-MFP	Master Fire Phone	Enables system to incorporate 2 way communication Included with /P panels
VX-SSC	Switch Scan Card	Included in basic panels, up to 7 additional cards may be added
VX-SLC	Switch LED Card	16 Switch LED Bank, up to 8 per VX-SSC
VX-IOI	Input Interface Card	One included with basic panel, additional cards give 16 control maximum of 8.

technical characteristics

Primary Power: 220 VAC
24VDC Battery Power

Electrical Ratings:
All Circuits @ 24VDC

Communications Bus:
RS-485 Standard
1M Baud data rate, Category 5 cable.

Master Panel

	Standby	Alarm	
ZVX-DCC	80mA	80mA	Voltage: 5V peak-to-peak max.
ZVX-ASC	30mA	30mA	Current: 50mA max.
ZVX-MFP	10mA	10mA	Impedance: 120 Ohms
ZVX-SSC	25mA	25mA	(max. imp. between panels)
			Frequency: 1.024 MHz
ZVX-SLC	6mA	6mA	
ZVX-MMC	45mA	45mA	
ZVX-IOI	20mA	20mA	

Backbox Dim: 36.8 x 68.6 x 10.2cm w-h-d
Color: Cool Grey 1c.

system configuration

Basic System Includes: Master Panel (ZVX-MP)
Master Mic Control
16 Switch Control Points
Dual Channel DMR
High Speed Communication Loop

Optional
Integrated Master Fire Phone

Area-of-Rescue

Maximum System Configuration
Up to 1000 Monitor and Control Points

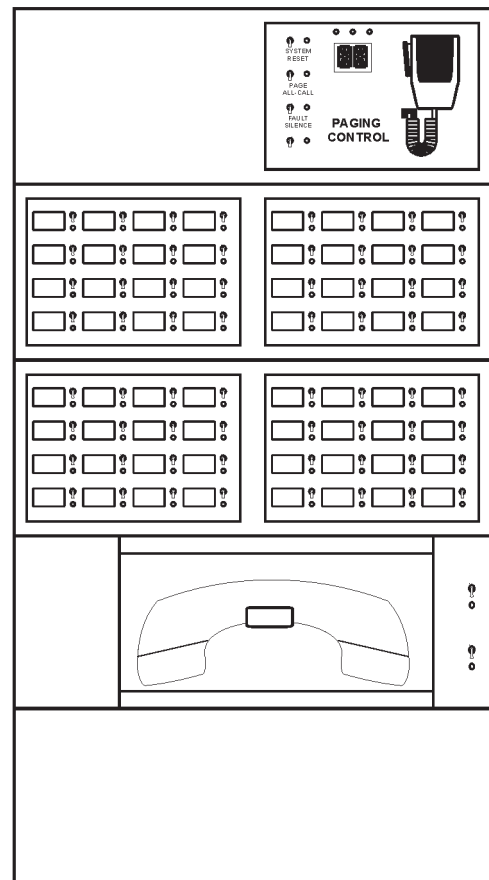

ZVX-MP64/P shown

373 (0604)

Specifications are subject to change without notice. Specifications are provided for information only and no responsibility is assumed by Morley-IAS Fire Systems for their use.